

CREWS RECREATION CENTER - RENTAL INFORMATION

GYMNASIUM

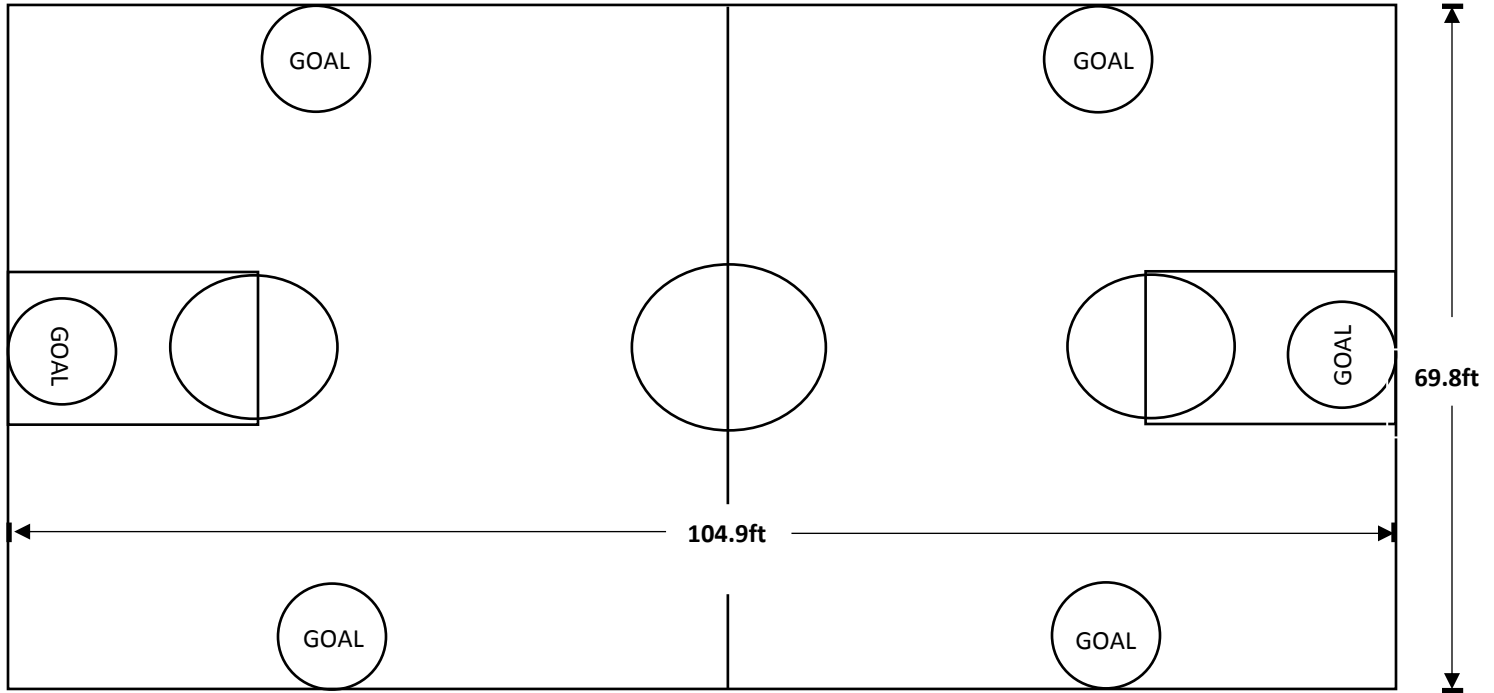

(r) resident is in 28105 zip code **(nr)** non-resident

½ Court Gym - **\$25r/30nr HOUR**

Full Court Gym - **\$50r/60nr HOUR**

NOTES:

- Any rental that goes past or before our usual closing/opening hours will be charged an **extra \$20 dollars** an hour
- Hours of Operation are: M-Th 12pm-9pm; Fri 12pm-6pm; Sat 10am-6pm; Sun 12pm-6pm

CREWS RECREATION CENTER - RENTAL INFORMATION

MULTIPURPOSE ROOMS

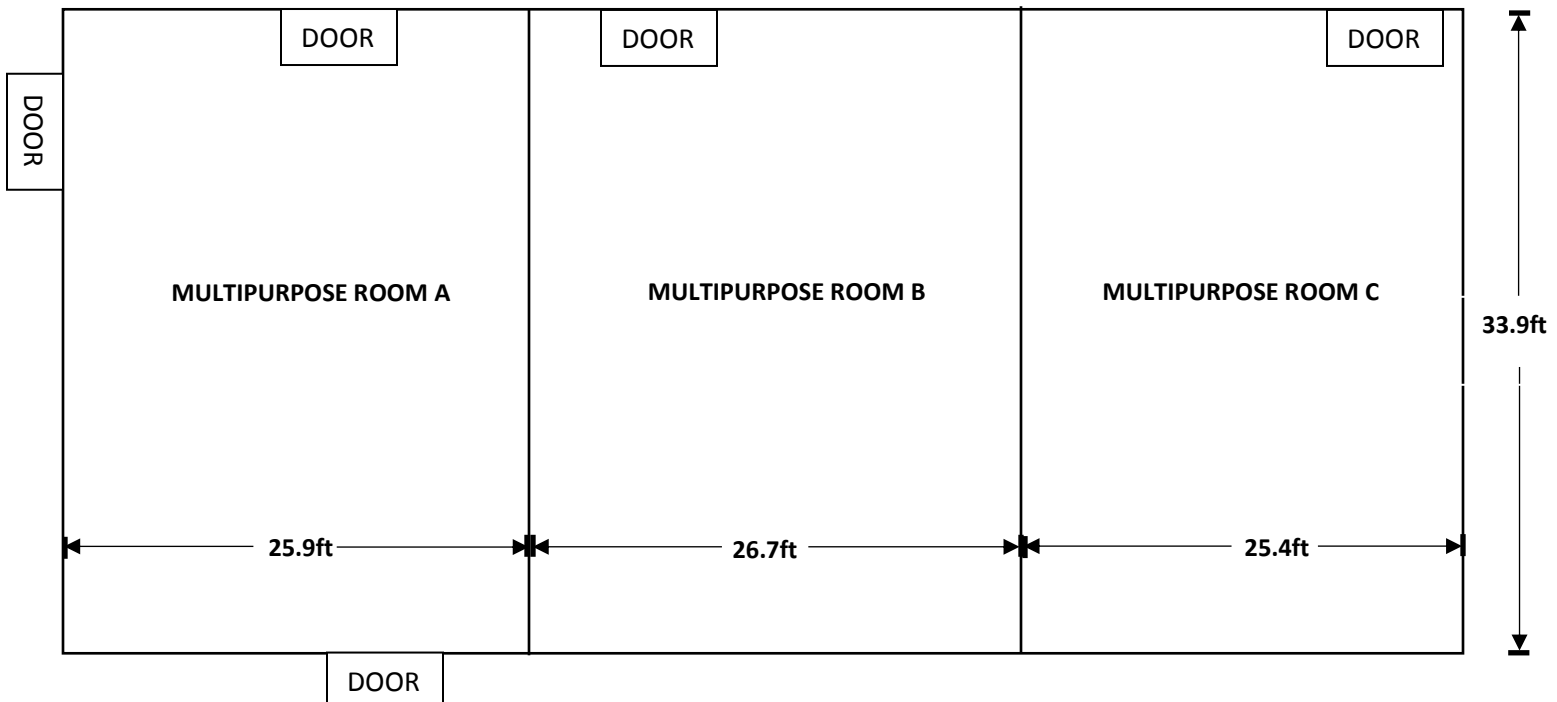

(r) resident is in 28105 zip code **(nr)** non-resident

- 1 Multipurpose Room - **\$30r/40nr HOUR**
- 2 Multipurpose Rooms - **\$40r/50nr HOUR**
- 3 Multipurpose Rooms - **\$50r/60nr HOUR**

Safety Deposit - \$100 for rental without food
\$200 for rental with food

NOTES:

- Each MP room can fit between 30-40 people.
- Sink and Counter available in MPA, tables and chairs are also available.
- Alcohol is not allowed on the premises
- Any rental that goes past or before our usual closing/opening hours will be charged an **extra \$20 dollars** an hour
- Hours of Operation are: M-Th 12pm-9pm; Fri 12pm-6pm; Sat 10am-6pm; Sun 12pm-6pm

Contact Charles Smith at (704) 708-1289 or via email at csmith@matthewsnc.gov for availability or if you have any additional questions.